

Aldreds
Estate Agents



47 Shrublands Way

Gorleston, NR31 8DU

£180,000



47 Shrublands Way

Gorleston, NR31 8DU

Chain Free This well-presented two bedroom semi-detached bungalow is ideally suited to those seeking comfortable ground floor living in a convenient central location. The property has recently been painted internally and re-carpeted, creating a fresh and welcoming feel, while double glazing across the home enhances comfort and efficiency.

Externally, the bungalow benefits from a generously sized rear garden, ideal for relaxing or entertaining, along with a detached garage to the rear, providing excellent storage and workshop potential, or secure parking. Situated close to a wide range of local amenities and well-served transport links, this property combines practicality with convenience and represents an excellent opportunity for downsizers, first-time buyers or investors alike.

Entrance Hall

Double glazed door to the side, tile floor, access to lounge, kitchen, bathroom.

Lounge

12'5" x 11'1" (3.8m x 3.4m)

Laminate floor, double glazed window to side, gas fire with back boiler, airing cupboard, radiator, access inner hall.

Inner Hall

Combination of laminate and carpet floor, access to bedrooms 1 and 2.

Bedroom 1

12'5" x 12'1" (into bay window) (3.8m x 3.7m (into bay window))

Carpet floor, radiator, double glazed bay window to front, log burner.

Bedroom 2

9'2" x 8'10" (2.8m x 2.7m)

Carpet floor, radiator, double glazed window to side.

Kitchen

5'10" x 8'6" (1.8m x 2.6m)

Tiled floor, double glazed window to rear, laminate counter tops with under and above storage, space for cooker, washing machine and under counter fridge, sink and draining board, radiator.

Bathroom

5'6" x 4'11" (1.7m x 1.5m)

Tiled floor, double glazed window to rear, loft hatch, WC, basin, bath tub with wall mounted electric shower and shower screen.

Garage

Concrete floor, up and over door to the rear, double glazed door to the side.





Outside Front

Concrete path leading the side and rear, decorative shingle area, brick wall boundary.

Outside Rear

Combination of grass lawn, patio and pathway, brick built shed, garage with side access and availability for parking in front of it.

Tenure

Freehold

Services

Mains gas (back boiler), water, electric, drainage.

Council Tax

Great Yarmouth Borough Council - Band B

Location

Gorleston-on-Sea is a coastal town 2 miles from Great Yarmouth centre and has a varied selection of local shops * Golf Course * Modern District hospital * Schools for all ages * Library * Regular bus services to the main shopping areas and a sandy beach.

Directions

From the Gorleston office head south along the High Street, at the traffic lights turn right into Church Lane, continue over the roundabout, at the next set of traffic lights turn right into Shrublands Way where the property can be found on the right hand side.

What 3 Words

///seagulls.masterpiece.snoozing

Ref

G18425/01/25



Floor Plan

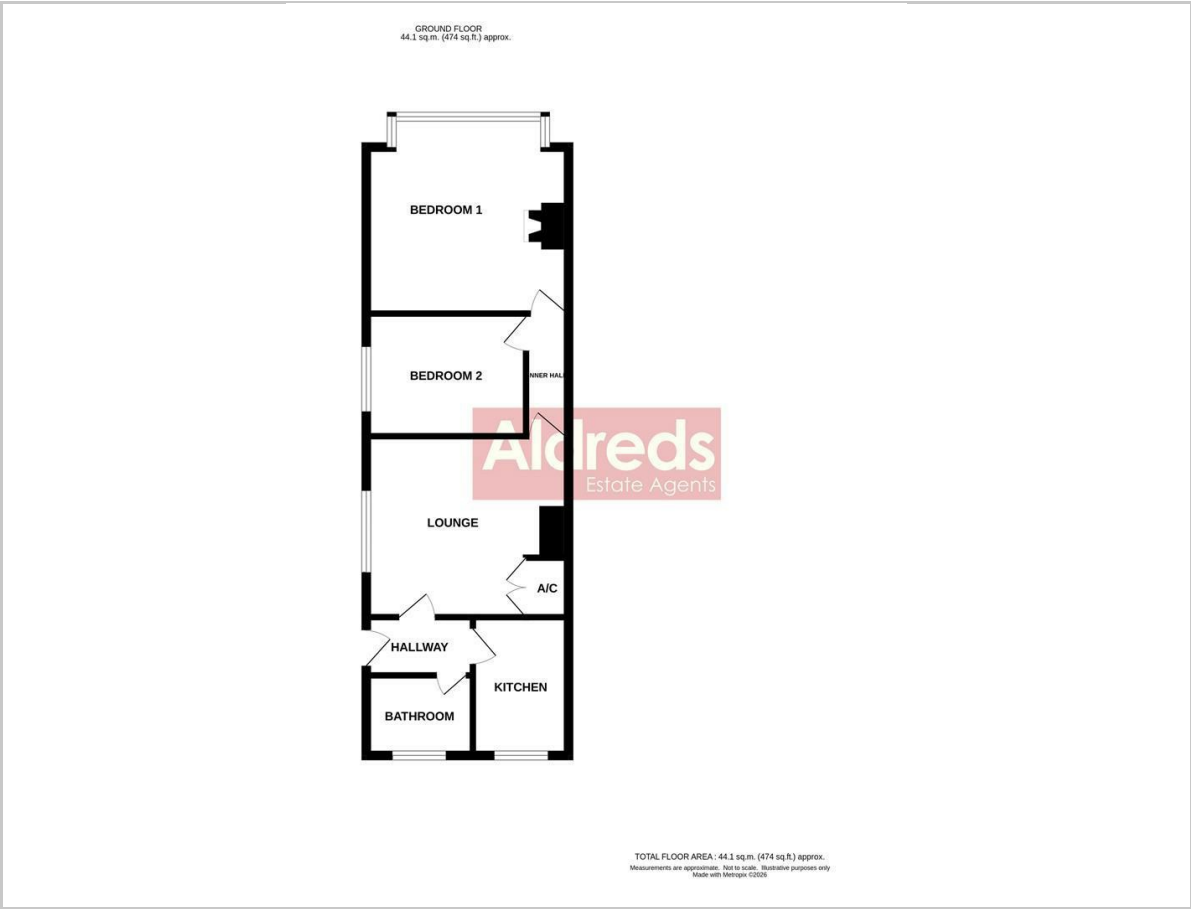

Viewing

Please contact our Aldreds Gorleston Office on 01493 664600 if you wish to arrange a viewing appointment for this property or require further information.

Disclaimer
These particulars are issued on an understanding that all negotiations shall be conducted through Messrs. Aldreds. Please note: Messrs. Aldreds for themselves and for the vendors or lessors of this property whose agents they are given notice that: 1. Particulars are set out as a general outline only for guidance of intending purchasers or lessees, and do not constitute nor constitute part of, an offer or contract. 2. All descriptions, dimensions, references to condition and necessary permissions for use and occupation, and other details are given without responsibility and any intending purchasers or tenants should not rely on them as statements or representations of fact but must satisfy themselves by inspection or otherwise as to the correctness of each of them. 3. No person in the employment of Messrs. Aldreds has any authority to make or give any representation or warranty whatever in relation to this property. 4. If you are proposing to visit the property and are travelling some distance please check with Aldreds on the issue of availability prior to travelling. 5. Aldreds Property Consultants and associated services may offer additional services to the prospective purchaser for which they will be entitled to receive a commission. Aldreds are pleased to be working with Mortgage Advice Bureau. They're an award-winning mortgage broker with over 1,400 advisers across the UK, and have access to over 12,000 mortgage products from over 90 lenders. Aldreds Estate Agents Ltd receive a commission of £200 on each completed case. Your home may be repossessed if you do not keep up repayments on your mortgage. There may be a fee for mortgage advice. The actual amount you pay will depend upon your circumstances. The fee is up to 1%, but a typical fee is 0.3% of the amount borrowed. Mortgage Advice Bureau is a trading name of Mortgage Seeker Limited which is an appointed representative of Mortgage Advice Bureau Limited and Mortgage Advice Bureau (Derby) Limited which are authorised and regulated by the Financial Conduct Authority. Mortgage Seeker Limited Registered Office: Lovewell Blake, Sixty Six North Quay, Great Yarmouth, Norfolk, NR30 1HE. Registered in England Number: 03721415. 6. Potential purchasers should check with their providers that the broadband and mobile phone coverage they would require is available.

Area Map

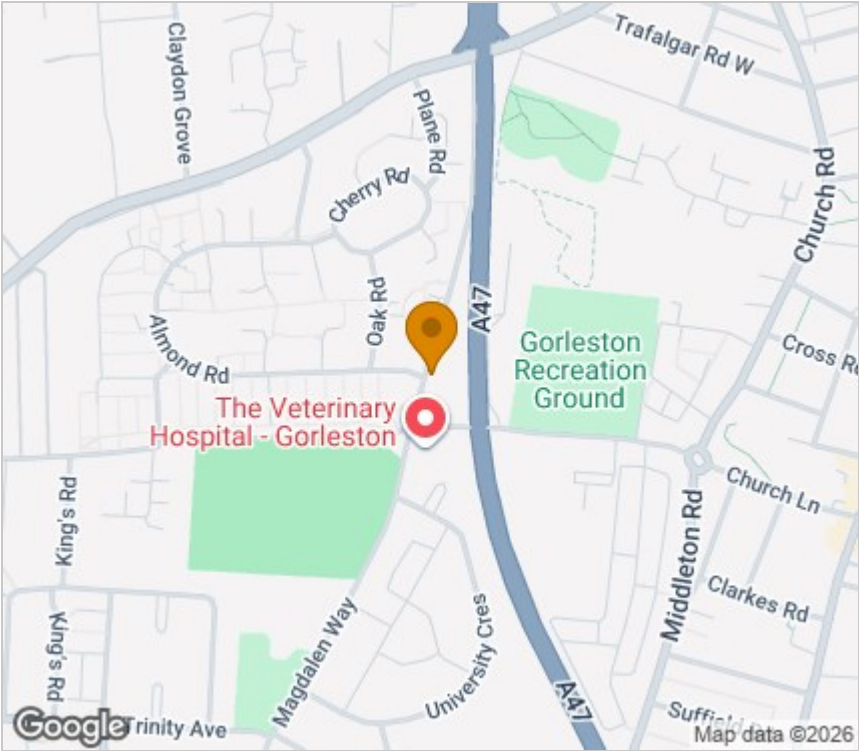

Energy Efficiency Graph

